



Gardeners Helping Gardeners Succeed

2450 S. Curry Street, Carson City, NV 89703

Tel:775-882-8600 Fax:775-882-7285

License #16114

www.greenhousegardencenter.com

Hardscape

Hardscape

The three natural elements that are essential qualities to transforming an outdoor space into an unforgettable place are color, shape and texture. When these elements are crafted to work in harmony, the result is nothing short of amazing.

Color

Don't be afraid of color. The best advice when choosing paver colors is to select hues that work in harmony with your home environment. Choose pavers with similar tones for a coordinated effect. Light colors reflect the light and open up an area. Darker tones absorb light and make areas appear smaller. When using large expanses of paler colored pavers, break the vista with large-scale plantings. Pavers a few shades lighter than the color of your house won't compete for attention. Gray-toned pavers used with brick houses eliminate the urge to try to match everything. Brick-colored pavers add warmth to wood or stone houses. Avoid monotony by combining two colors or by using pavers with blended colors. A multicolor blend is a paver with more than one color. Multicolored pavers blend better with their surroundings. Most minor stains are thoroughly camouflaged in the multitude of hues and tones. Color mixes can consist of blends of up to four colors that harmonize well together and give a surface an interesting and dynamic appearance. Color is a powerful decorating tool that can visually expand or contract an area and add the impression of light or depth, warmth or coolness. Finally, consider where the sun hits an area, how long it stays sunny in that location and how much shade is cast there.

Shape

The patterns you choose will help create the unique look you are after. Here are a few helpful tips. For structures with simple, straight lines and little ornamentation, pavers with interesting shapes installed in a simple geometric pattern work nicely. For ornate Victorian-style houses, repeated curves of arched windows and doors can be echoed through the design of curved edges. For rectangular, colonial styles, repeat the shape by using brick-shaped pavers. For brick homes, pavers larger than the brick used in the home or cobble-style pavers are a good choice. Narrow spaces like paths and alleys can be designed to appear wider simply by laying the pavers on a diagonal or in rows running across the area. Wide spaces can seem narrower simply by running rectangular pavers the length of the area. Large expanses require greater visual interest and provide a great opportunity to let your imagination run free with circles, curves, and fan-shaped patterns.

Texture

You don't have to settle on one texture to create a stunning hardscape. Adding multiple textures to your hardscape can add more overall interest. Textures can be suited to meet your practical needs as well. Smoother, more rounded surfaces are ideal in high traffic areas or swimming pool decks. Rough textured surfaces are perfect for more relaxed areas, like patios and porches, and are excellent for creating accents and borders. Natural textures are characterized by uneven contouring in varying degrees to create a more organic look. Antiqued textures may feature the rugged, time-honored look of old Europe. Classic texture is characterized by a smooth surface with angles or rounded with angles or rounded chamfer.

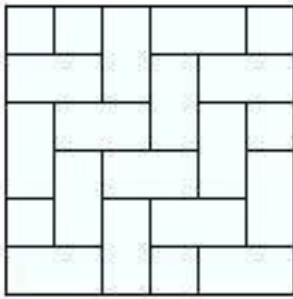

Herringbone 90°

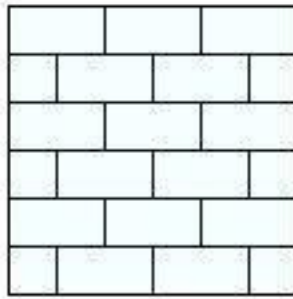

Stretcher Bond

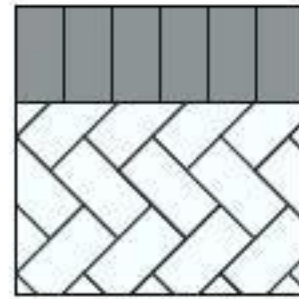

Soldier Header



Herringbone 45°

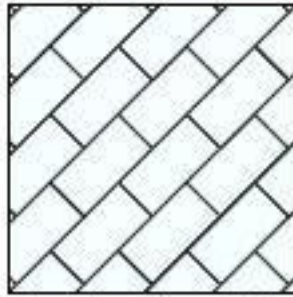

Stretcher Bond 45°

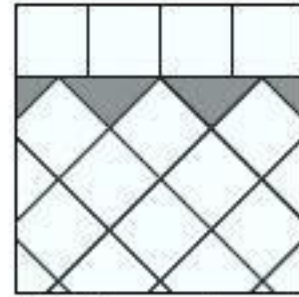

Half Diamond Inlay

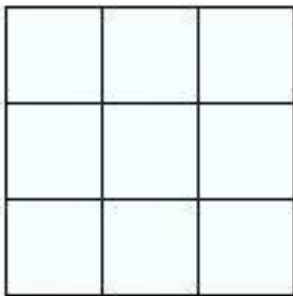

Stack Bond

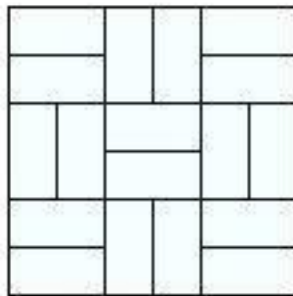

Basket Weave

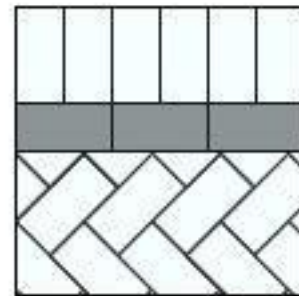

Pencil Line Inlay



Diamond

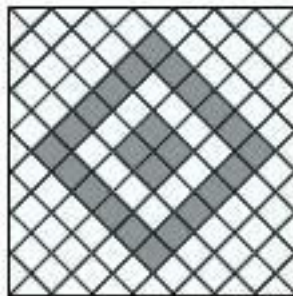

Contrasting Pattern

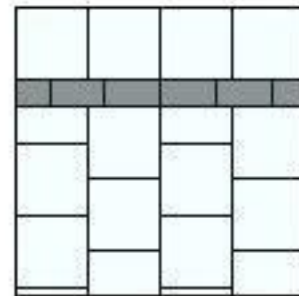

Stretcher Bond Inlay

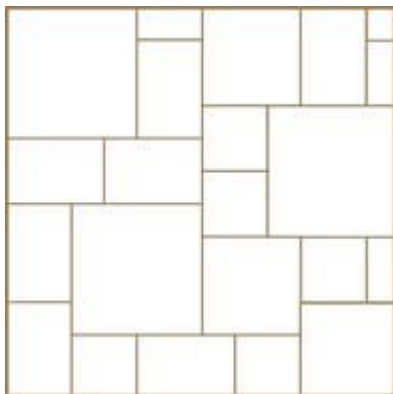

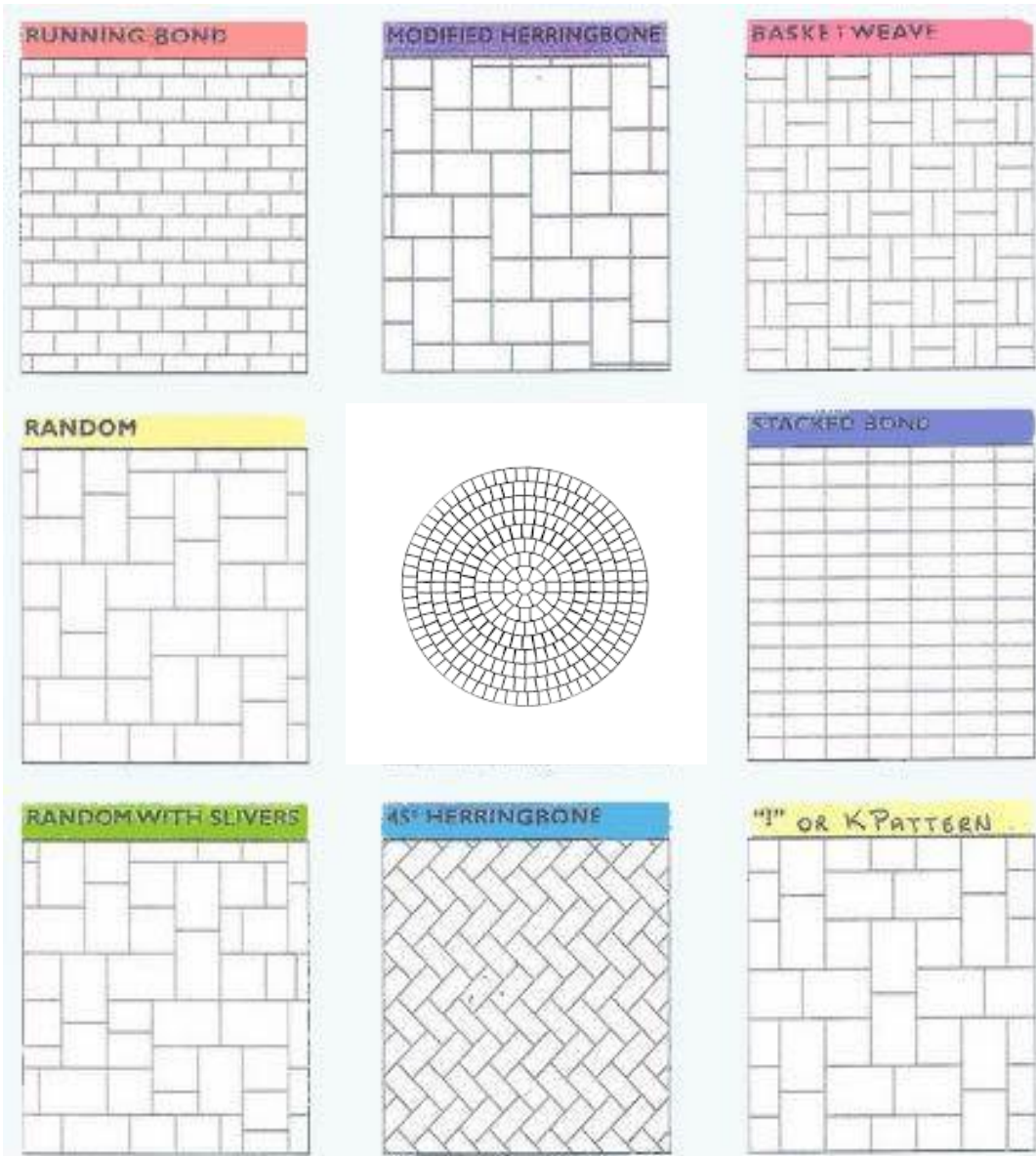
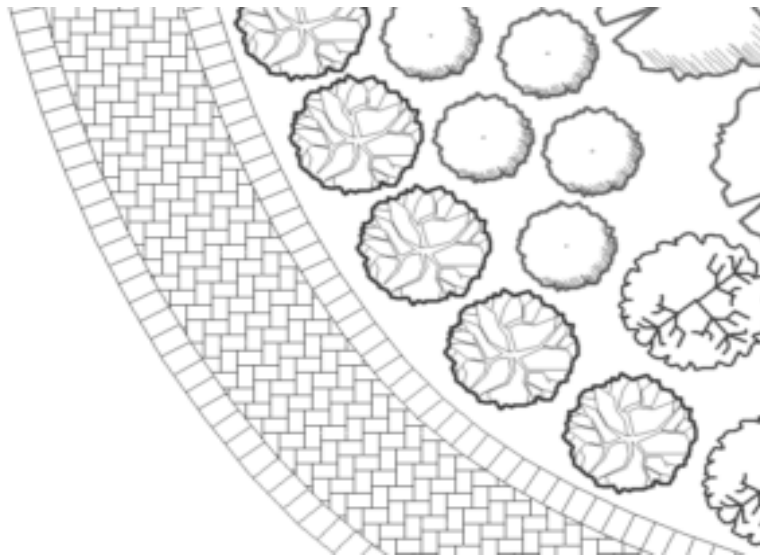



Permeable Installation

